

SCREW & BARREL

- Nitrided
- Bimetallic

Since 1974

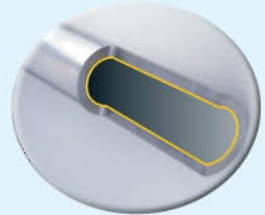
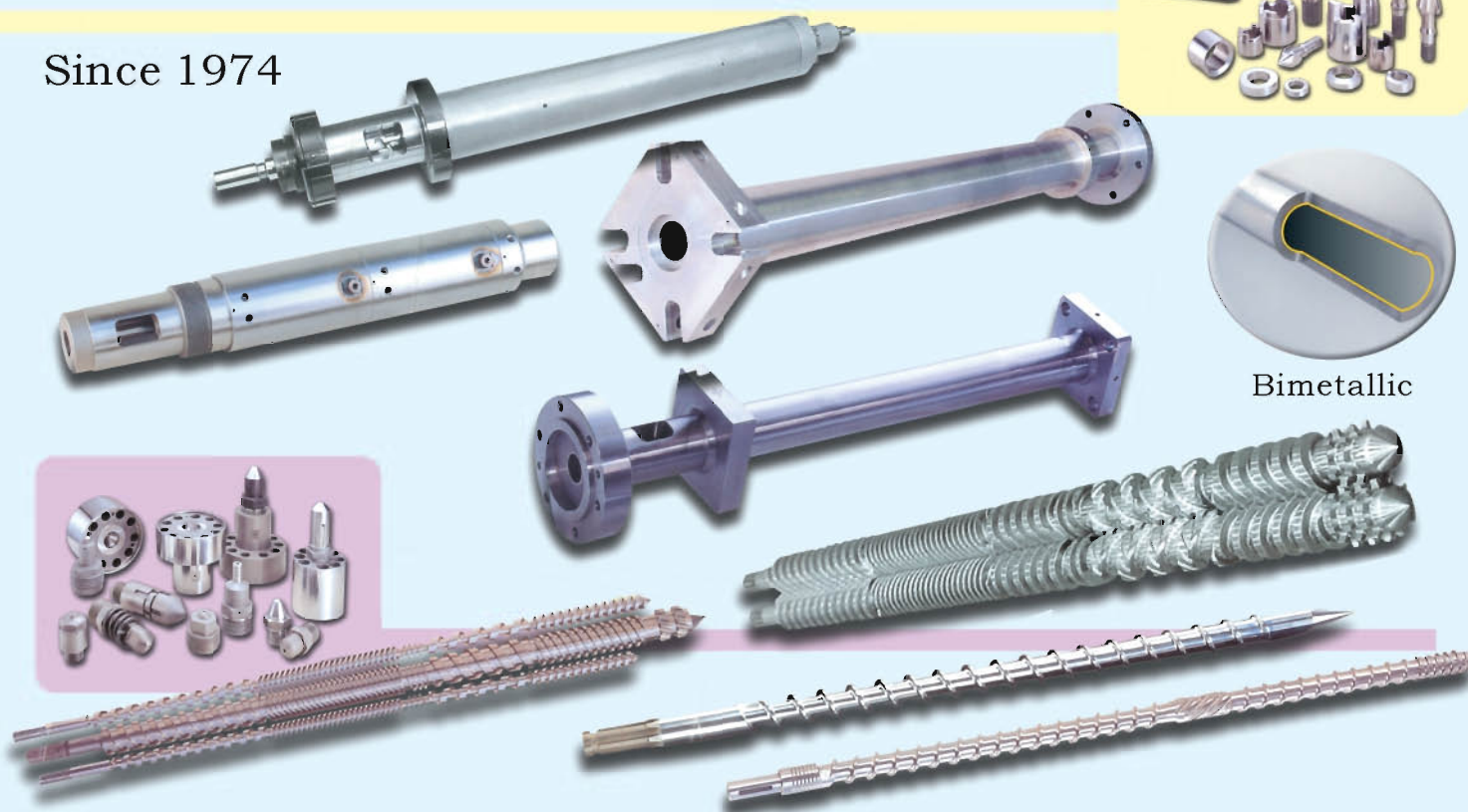

Bimetallic



Surface Spray Coating



PTA Screw Welding Equipment



CNC Screw Root Grinding Machine

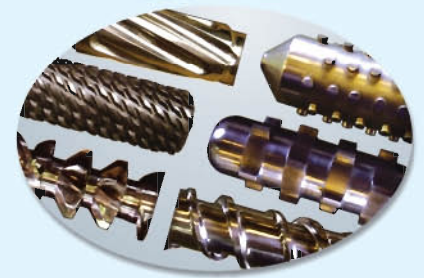

Various Mixing Splines



Bimetallic Centrifugal Furnace



Nitriding Furnaces



Precision Honing Machine



Spiral Grooved Feeding

WORK ABILITY

- Nitrided : Screw D250*8000, Barrel OD 450*6000 / ID 280-14
- Bimetallic : Screw D250*7000, Barrel OD 320*4000 / ID 200-14

MAIN PRODUCTS

- Nitrided Screw & Barrel
- Bimetallic, PTA Bimetallic Alloy Screw
- Bimetallic, HP/HVOF Spray Coated Screw
- Bimetallic Barrel Blank (Ni / Fe / Co Base)

APPLICATION

- Injection Molding Machine
- Bakelite Molding Machine
- Rubber Molding Machine
- Extruder



將貿興業有限公司 台灣省台南市安平工業區新義路33號
GENEMAX INDUSTRIAL INC.

33,Shin-Yi Road, An-Ping Industrial District, Tainan 702, Taiwan.

Tel: 886-6-263-7999 (Rep.) Fax: 886-6-263-7950

http://www.gmx.com.tw E-mail: genemax@seed.net.tw ; service@gmx.com.tw

