

Gear Boxes for plastic extruding machines

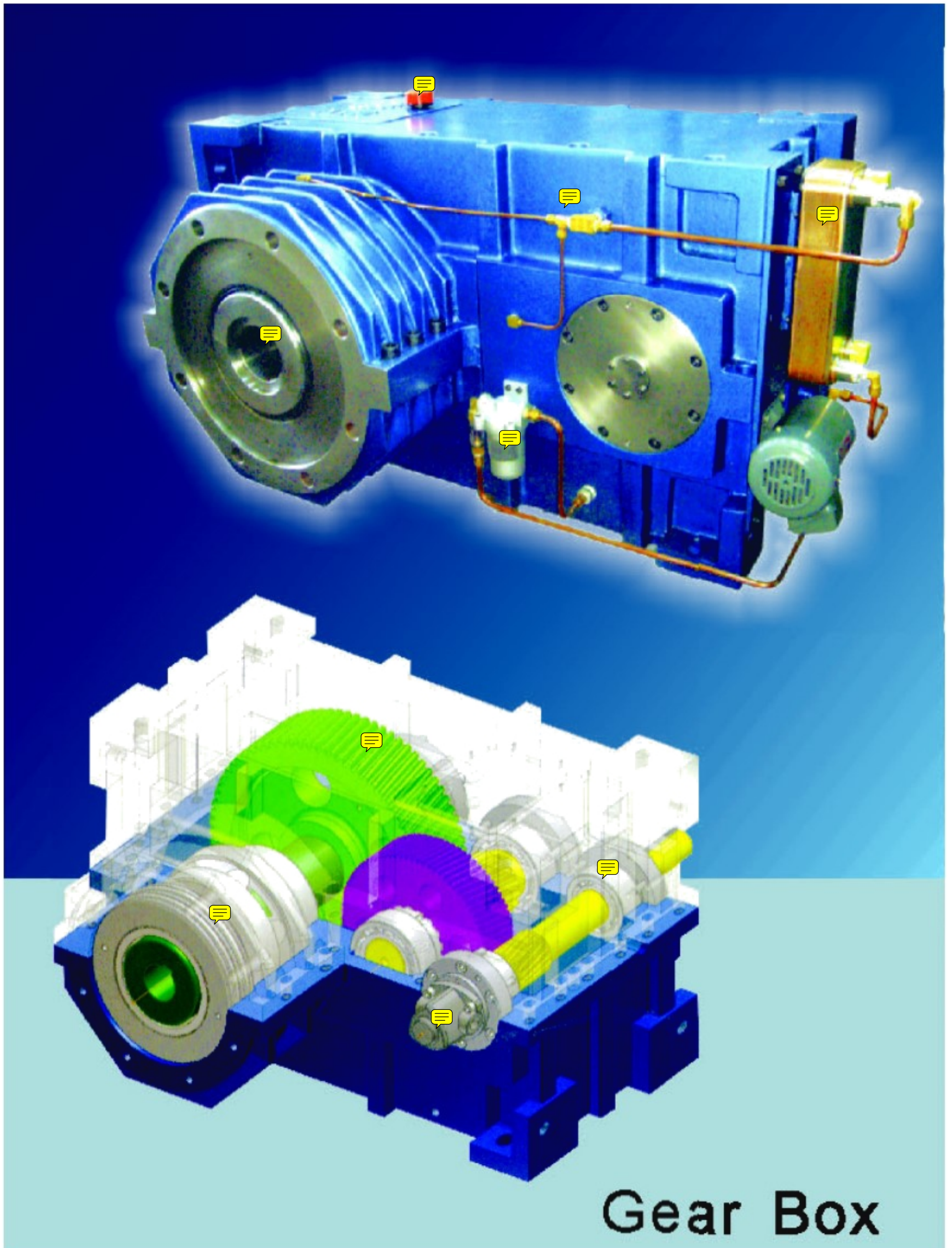

SPECIFICATION FOR for Three-axis gear box

Type	Anti-Thrust Bearing	Max Horsepower	Screw Dia (mm)	Output Shaft I.D (mm)	Input Shaft O.D (mm)	Input Shaft Torque (kg-m)	Gear Ratio			Center From Ground	Remark
							Standard		Max.		
SLF 5	29412	7.5HP / 5.7KW	15~25	10~25	22	6	20:1	25:1	30:1	120	L
SLF10	29414	15HP / 12 KW	30~40	20~35	28	9	20:1	25:1	30:1	155	L
SLF20	29416	25HP / 19KW	40~50	30~40	30	12	20:1	25:1	30:1	175	L
SLF40	29422	40HP / 30 KW	45~65	40~60	40	23	20:1	25:1	30:1	200	C、L
SLF50	29424	50HP / 38KW	65~75	50~70	50	36	20:1	25:1	30:1	240	C、F、L
SLF75	29426	75HP / 57 KW	75~90	60~80	55	50	20:1	25:1	30:1	260	C、F、L、H
SLF100	29428	100HP / 75 KW	85~100	70~90	60	60	20:1	25:1	30:1	285	C、F、L、H
SLF200	29436	200HP /150KW	120~150	90~110	85	121	20:1	25:1	30:1	375	C、F、L、H

Remarks:

1. Type of selection is subject to max horsepower and thrust-bearing mainly. (Dia of Screw is for reference only.)
2. Standard Gear Ratio 20:1、25:1、30:1.
Other gear ratio is also available upon request.
3. Steel Grade: shaft by Forged SNCM220 (AISI 8620, DIN 17CrNiMo6), output shaft by SCM440 (AISI 4140, DIN 40 CrMo4), gear and pinion by SCM415 (AISI 4115, DIN 20CrMo5).
4. Gear grinding precision at class JIS 0~2.
5. All Bearing: SKF Sweden / FAG Germany
6. All Seal location with hard-chrome plating.
7. All seal: NOK Japan
8. Casing: FC25
9. Cooling: built-in cooling filter system and plate type heat-exchanger.

10. In-house test and inspection: noise below 85 dB and vibration less than 2 mm/ sec.
11. In case of directly coupling with motor, the additional motor fixed flange and coupling are needed.
12. C: inside cooling pipe, (Note: included for SLFA and SLFC only which output force from right-hand or left-hand.
Inside cooling pipe is not included for SLFB and SLFD which output force from bottom or top to avoid accumulation of impurity)
F: oil filter,
L: pump forced lubrication for all of bearings,
H: plate type heat-exchanger (SLF10~SLF50 can purchase additional plate type heat-exchanger as request.)
13. Above specification is for four-axis gear box only.
14. Three-axis is also available upon request by a separate specification. (SL type)
15. Input force of either Front orientation or Rear orientation is available, please refer to the specification of outline dimensions separately.
16. Input force of rear orientation by direct coupling is available, please refer to the specification of outline dimensions separately.

SLF型 四軸後入力(SLF5~SLF40)

SLF Type four-axis rear orientation input force

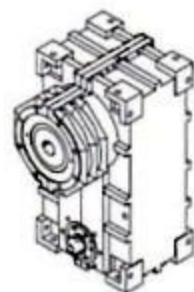
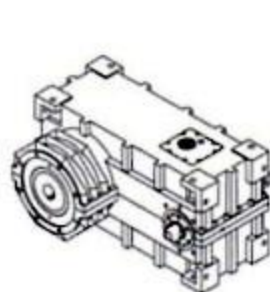
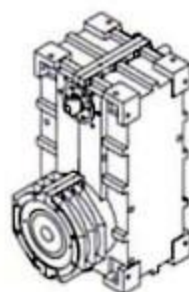
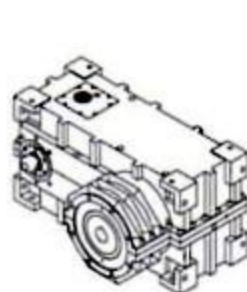
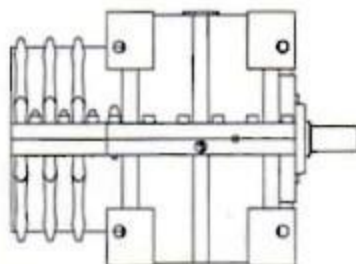
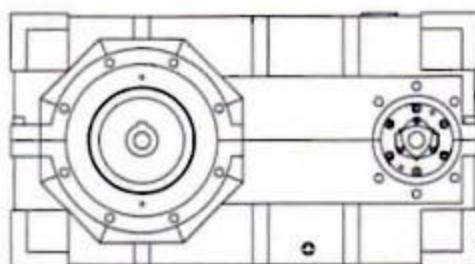

SLFA 右出力
right-hand

SLFB 下出力
down

SLFC 左出力
left-hand

SLFD 上出力
up

SLF型 四軸前入力(SLF5~SLF40)

SLF Type four-axis front orientation input force

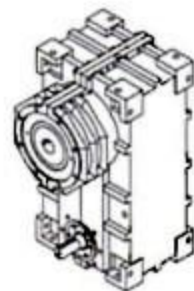
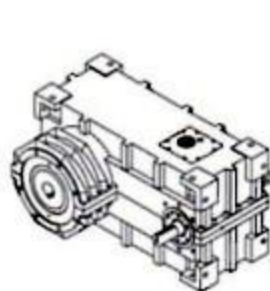
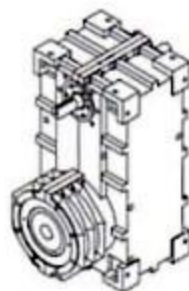
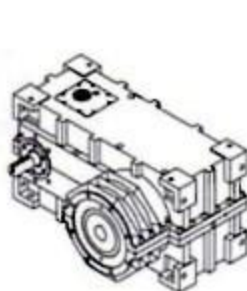
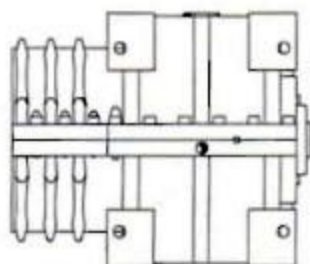
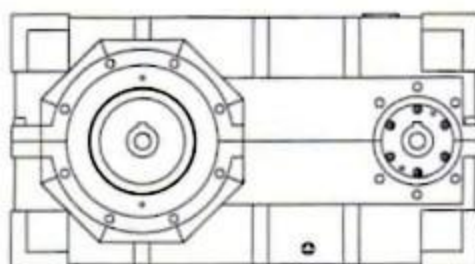

SLFAB 右出力
right-hand

SLFBB 下出力
down

SLFCB 左出力
left-hand

SLFDB 上出力
up

SLF型 四軸後入力(SLF50~SLF500)

SLF Type four-axis rear orientation input force

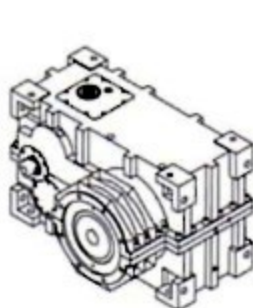
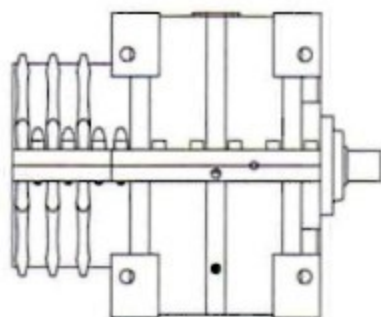
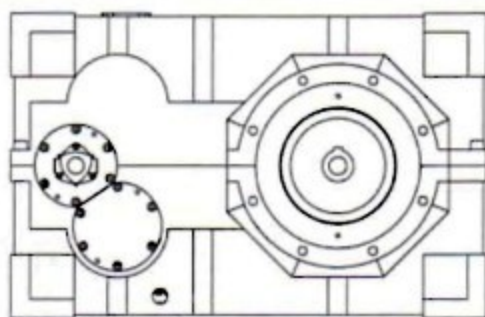

SLFA 右出力
right-hand

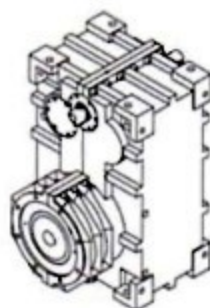

SLFB 下出力
down

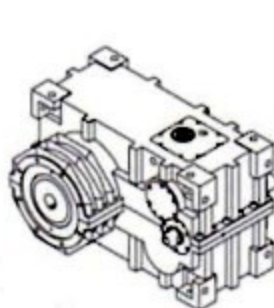

SLFC 左出力
left-hand

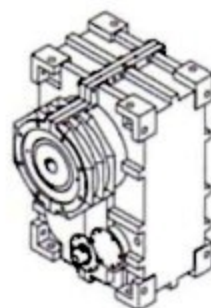

SLFD 上出力
up

SLF型 四軸前入力(SLF50~SLF500)

SLF Type four-axis front orientation input force

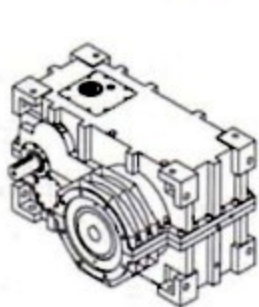
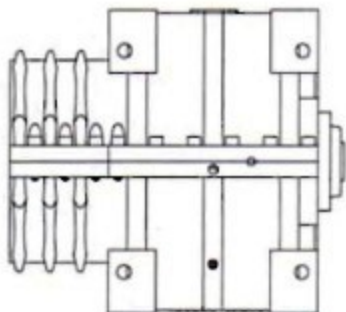
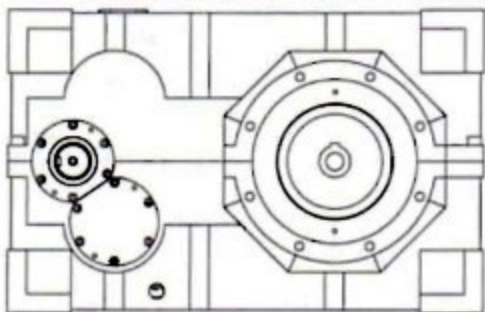

SLFAB 右出力
right-hand

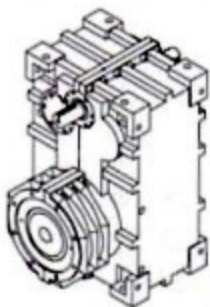

SLFBB 下出力
down

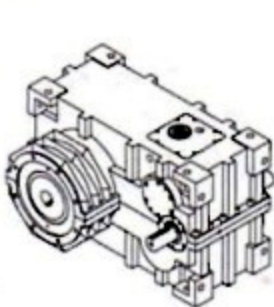

SLFCB 左出力
left-hand

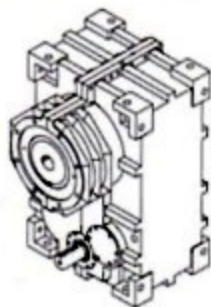

SLFDB 上出力
up

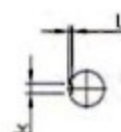
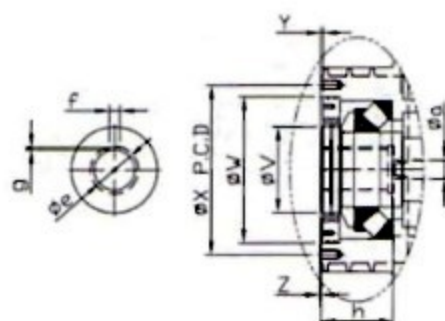
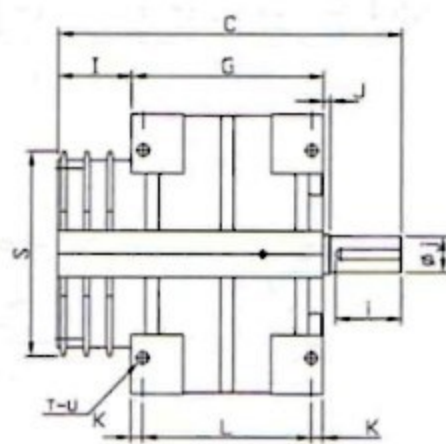
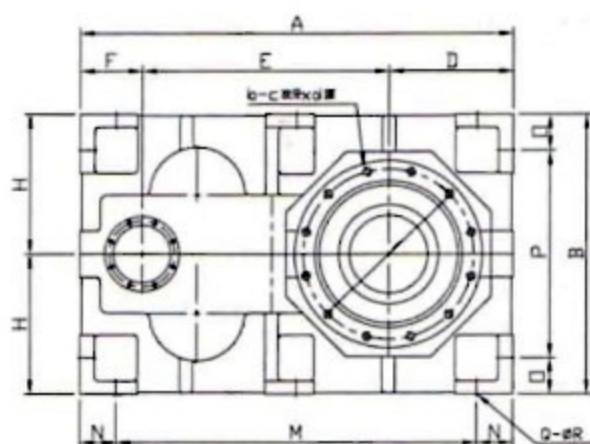

	外型尺寸 Profile Dimension										安裝尺寸 Installation Dimension										
	A	B	C	D	E	F	G	H	I	J	K	L	N	M	O	P	Q	R	T	U	
SLF-50	750	480	580	235	413	102	330	240	155	5	25	280	65	620	65	350	4	22	12	M20	
SLF-75	830	520	640	253	462	115	375	260	160	5	25	325	77.5	675	77.5	365	4	22	12	M20	
SLF-100	860	570	710	267	470	123	420	285	170	10	30	360	75	710	75	420	4	26	12	M24	
SLF-150	980	640	830	290	553	137	495	320	185	10	35	425	85	810	85	470	4	26	12	M24	
SLF-200	1120	750	915	343	607	170	540	375	205	10	35	470	95	930	95	560	6	26	14	M24	
SLF-300	1250	850	1010	368	702	180	590	425	220	20	40	510	115	1020	115	620	6	33	14	M32	
SLF-400	1400	900	1056	410	790	200	595	450	260	21	35	525	125	1150	122.5	655	6	33	14	M32	
SLF-500	1500	970	1140	431	854	215	665	485	255	20	40	585	125	1250	125	720	6	40	14	M38	
	出力軸尺寸 Output Shaft Dimension										入力軸尺寸 Input Shaft Dimension										止推軸承 thrust bearing
	S	V	W	X	Y	Z	a	b	c	d	e	f	g	h	i	j	k	l			
SLF-50	350	150	260	300	9	5	28	8	M20	40	60	18	4.4	140	80	50	14	5.5	294	24E	
SLF-75	370	160	280	310	8	5	32	8	M20	50	60	18	4.4	145	90	55	16	6	294	26E	
SLF-100	400	170	290	330	11	6	34	8	M20	50	70	20	4.9	140	100	60	18	7	294	28E	
SLF-150	440	200	330	370	10	5	34	8	M24	60	80	22	5.4	160	135	70	20	7.5	294	32E	
SLF-200	510	220	380	430	14	5	40	8	M30	60	90	25	5.4	185	151	85	22	9	294	36E	
SLF-300	540	230	410	460	14	6	40	8	M30	60	100	28	6.4	185	162.5	90	25	9	294	44E	
SLF-400	650	250	450	530	14	5	65	12	M30	60	120	32	7.4	220	162.5	90	25	9	294	48E	
SLF-500	710	300	510	590	10	5	65	12	M30	60	140	36	8.4	250	184	100	28	10	294	52E	

SLF型 四軸後直接 (SLF5~SLF40)

SLF Type four-axis rear orientation direct coupling

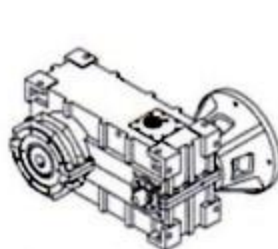
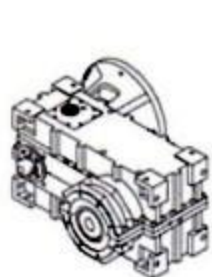
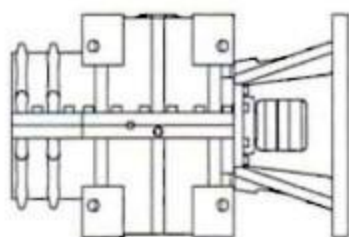
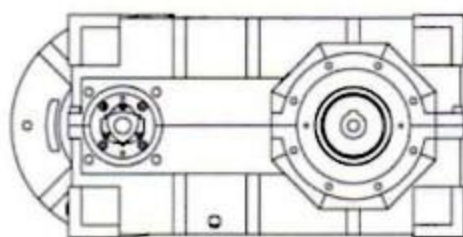

SLFAD 右出力 SLFBD 下出力 SLFCD 左出力 SLFDD 上出力
right-hand down left-hand up

SLF型 四軸前直接 (SLF5~SLF40)

SLF Type four-axis front orientation direct coupling

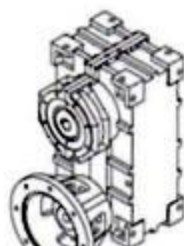
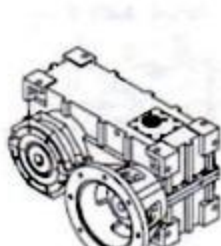
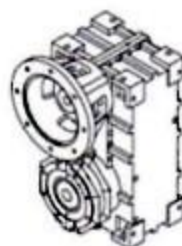
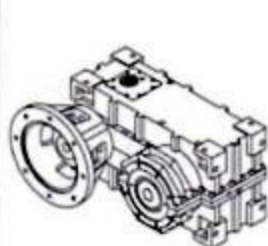
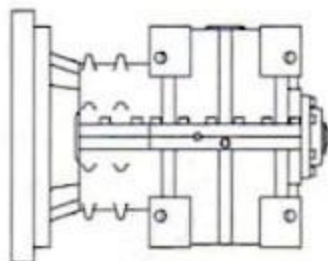
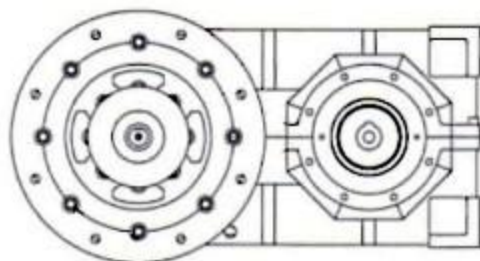

SLFAE 右出力 SLFBE 下出力 SLFCE 左出力 SLFDE 上出力
right-hand down left-hand up

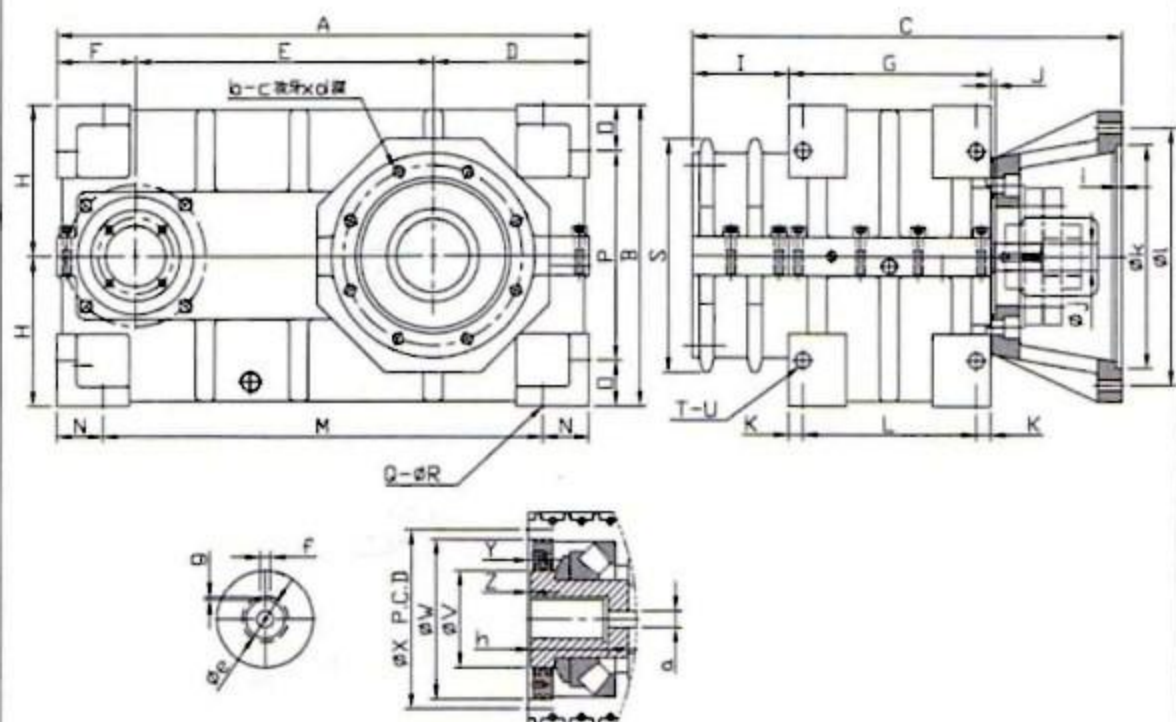

	外型尺寸										安裝尺寸										備註
	Profile Dimension										Installation Dimension										
	A	B	C	D	E	F	G	H	I	J	K	L	N	M	O	P	Q	R	T	U	
SLF-5	455	240	402	133	260	62	180	120	92	5	12	161	35	385	35	170	4	13	12	M12	
SLF-10	550	310	445	161	308	81	210	155	100	0	15	180	47.5	455	47.5	215	4	16	12	M14	
SLF-20	625	350	531	175	365	85	240	175	110	5	17.5	205	50	525	50	250	4	18	12	M16	
SLF-40	740	400	666	206	437	97	300	200	150	24	20	260	57.5	625	55	290	4	18	12	M18	
	出力軸尺寸														入力軸尺寸				止推軸承	備註	
	Output Shaft Dimension														Input Shaft Dimension						
	S	V	W	X	Y	Z	a	b	c	d	e	f	g	h	i	j	k	l	thrust bearing	note	
SLF-5	200	75	140	160	7	5	14	8	M12	30	24	8	3.3	55	6	22	180	215	29412E	5HP	
SLF-10	240	85	160	185	7	5	14	8	M12	30	30	10	3.3	75	6	28	230	265	29414E	7.5HP 10HP	
SLF-20	260	95	180	210	4	2	18	8	M16	40	40	12	3.3	85	6	30	250	300	29416E	15HP 20HP	
SLF-40	340	135	240	270	7	5	26	8	M20	50	50	14	3.8	130	7	40	300	350	29422E	30HP 40HP	

SLF型 四軸後直接(SLF50~SLF200)

SLF Type four-axis rear orientation direct coupling

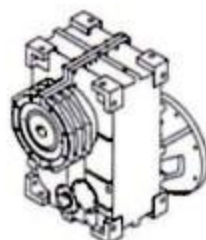
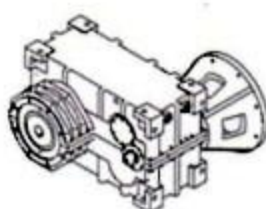
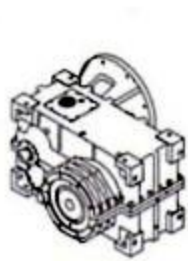
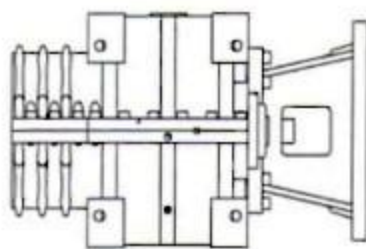
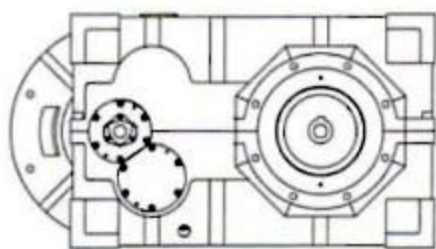

SLFAD 右出力 SLFBD 下出力 SLFCD 左出力 SLFDD 上出力
right-hand down left-hand up

SLF型 四軸前直接(SLF50~SLF200)

SLF Type four-axis front orientation direct coupling

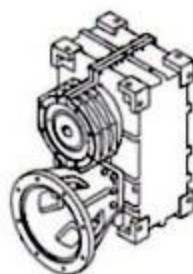
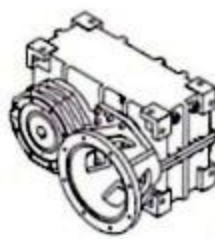
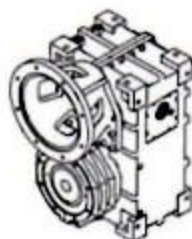
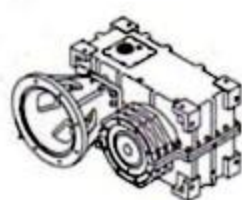
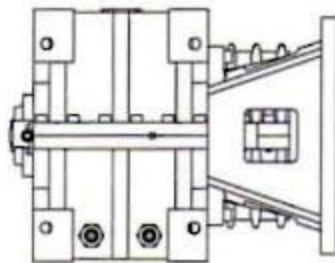
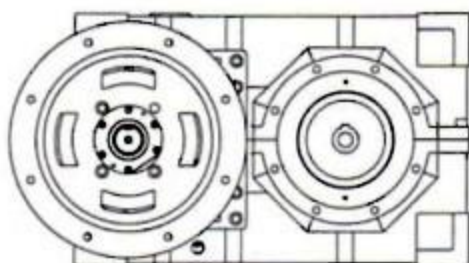

SLFAE 右出力 SLFBE 下出力 SLFCE 左出力 SLFDE 上出力
right-hand down left-hand up

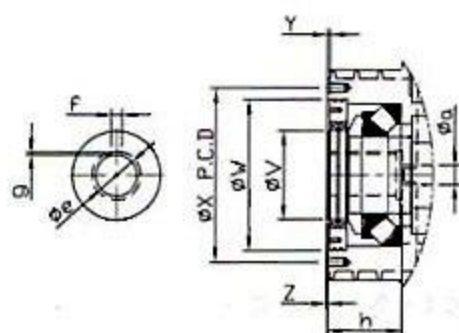
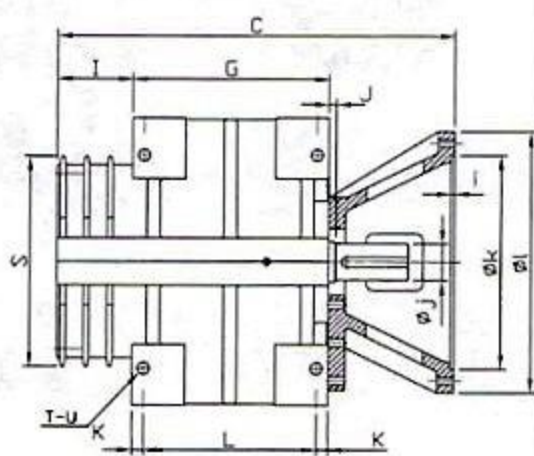
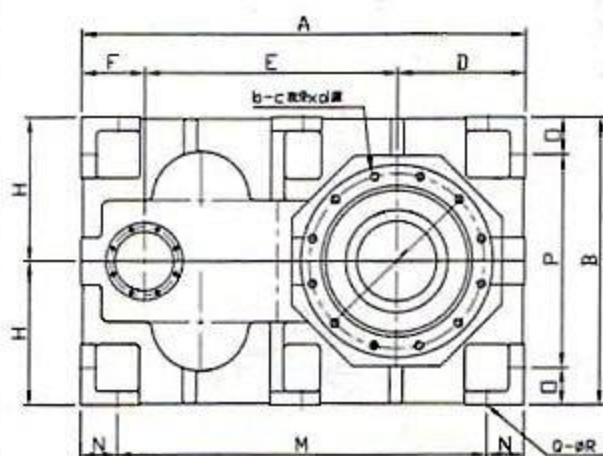

	外型尺寸 Profile Dimension										安装尺寸 Installation Dimension										
	A	B	C	D	E	F	G	H	I	J	K	L	N	M	O	P	Q	R	T	U	
SLF-50	750	480	730	235	413	102	330	240	155	5	25	280	65	620	65	350	4	22	12	M20	
SLF-75	830	520	790	253	462	115	375	260	160	5	25	325	77.5	675	77.5	365	4	22	12	M20	
SLF-100	860	570	855	267	470	123	420	285	170	10	30	360	75	710	75	420	4	26	12	M24	
SLF-150	980	640	1010	290	553	137	495	320	185	10	35	425	85	810	85	470	4	26	12	M24	
SLF-200	1120	750	1090	343	607	170	540	375	205	10	35	470	95	930	95	560	6	26	14	M24	
	出力轴尺寸 Output Shaft Dimension										入力轴尺寸 Input Shaft Dimension										止推轴承 thrust bearing
	S	V	W	X	Y	Z	a	b	c	d	e	f	g	h	i	j	k	l			
SLF-50	350	150	260	290	9	5	28	8	M16	40	60	18	4.4	140	80	50	350	450	29424E		
SLF-75	370	160	280	310	8	5	32	8	M20	50	60	18	4.4	145	90	55	450	550	29426E		
SLF-100	400	170	290	330	11	6	34	8	M20	50	70	20	4.9	140	100	60	450	550	29428E		
SLF-150	440	200	330	370	10	5	34	8	M24	60	80	22	5.4	160	135	70	550	660	29432E		
SLF-200	510	220	380	430	14	5	40	8	M30	60	90	25	5.4	185	151	85	550	660	29436E		



GENEMAX INDUSTRIAL INC.,

Alex Chen (General Manager)



Address: 33, SHIN-YI ROAD, AN-PING INDUSTRIAL DISTRICT, 702 TAINAN, TAIWAN.

Tel: 886-6-263-7999 (REP) Fax: 886-6-263-7950 Mobil: 886 - 937347477

E-mail: genemax@seed.net.tw ; service@gmx.com.tw

Website: www.gmx.com.tw

Skype: genemax2637999 



GENEMAX INDUSTRIAL INC.